

SECTION 1-1

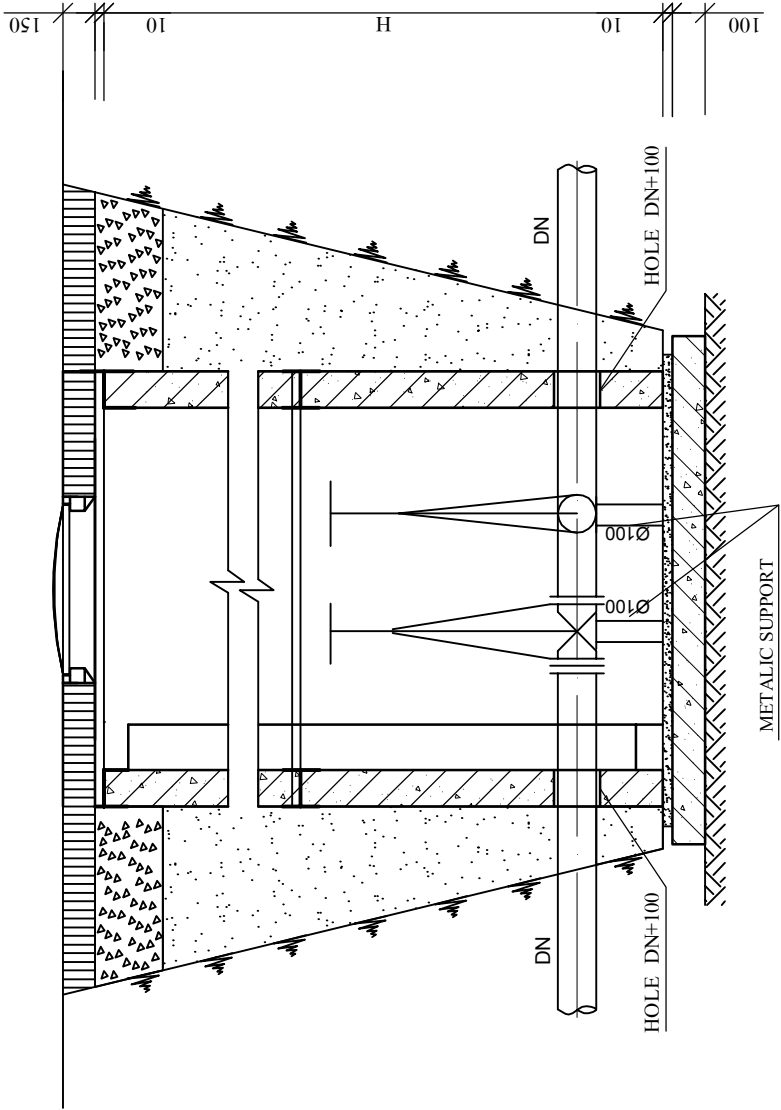

DN	L	H	D	e1	e2	Weight(weighth, kg)
Short (front to front) gate sluice						
50	150	≤241	165			≤11
65	170	≤271	185			≤14,5
80	180	≤297	200			≤18
100	190	≤334	220			≤23
125	200	≤376	250			≤31
150	210	≤448	285			≤46
200	230	≤562	340			≤65
Disc valve (double centrifugal)						
DN	L	H	D	e1	e2	Weight(weight , kg)
50						
65						
80						
100	190		≤220	≤110	≤320	≤35
125	200		≤250	≤125	≤331	≤38
150	210		≤302	≤151	≤352	≤43
200	230		≤360	≤174	≤377	≤73
Pressure regulation valve						
DN	L	H	D	e1	e2	Weight(weight , kg)
50	230	≤480	≤175	≤90	≤310	≤19
65	290	≤575	≤190	≤120	≤340	≤36
80	310	≤580	≤204	≤120	≤340	≤38
100	350	≤650	≤240	≤150	≤370	≤50
125	400	≤665	≤274	≤150	≤370	≤65
150	480	≤685	≤304	≤150	≤370	≤75
200	600	≤825	≤364	≤200	≤425	≤160
Filter						
DN	L	H	D	e1	e2	Weight(weight , kg)
50	230	≤160	≤170			≤12
65	290	≤180	≤195			≤17
80	310	≤215	≤210			≤23,3
100	350	≤240	≤240			≤34
125	400	≤280	≤270			≤42,5
150	480	≤360	≤295			≤61,2
200	600	≤405	≤360			≤116,5

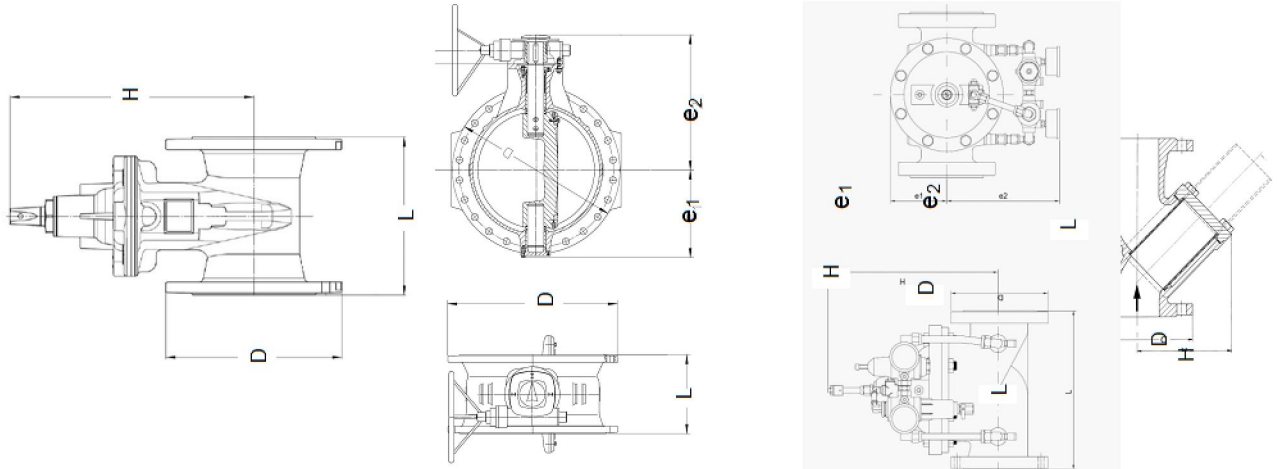

JINJ LTD
YEREVAN 2013

Client - Yerevan Municipality
"Municipal development project implementation unit" SI

WATER SUPPLY AND WASTEWATER
PROJECT - YEREVAN RPE PROJECT

Tender documents - general drawings

General installation scheme of installing device, equipments
in water supply round chambers

1 of 1